

CLARKE ROAD

EXISTING ENTRY

EXISTING 6 CAR BAYS TO BE BITUMEN

Exit

NEW ONE WAY EXIT TO HEAD WEST ON CLARKE ROAD ONLY (SUBJECT TO APPROVAL)

43 CARBAYS
(3 DISABLED BAYS)
5 PICK UP BAYS

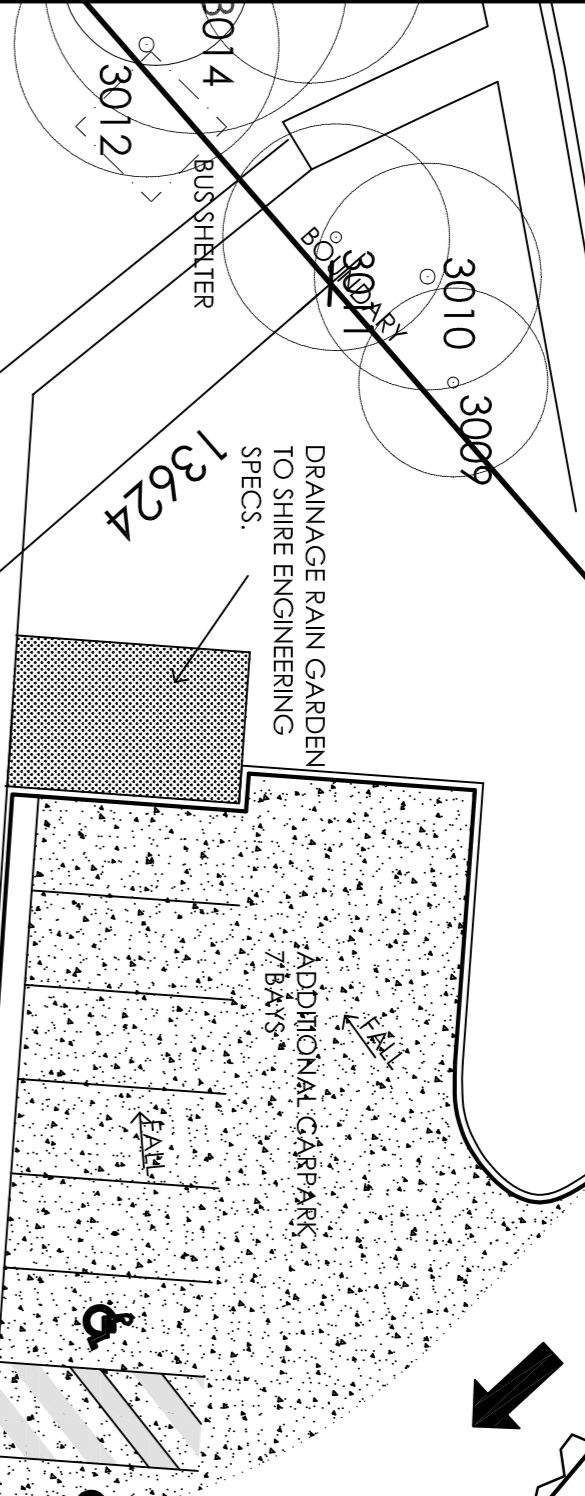

PROPOSED ADMINISTRATION BUILDING

NEW ENTRY GATE AREA

EXISTING NATIVE PEPPIE TREE MASONRY AND TIMBER SEATING SURROUND

NEW FENCE

EXISTING FENCE TO BE REMOVED

EXISTING ACCESS PATH TO BE REMOVED

RELOCATE EXISTING GARDEN SHED RE-ALIGN FENCE

EXISTING PATH

EXISTING FENCE

EXISTING PATH

EXISTING FENCE

EXISTING PATH

EXISTING FENCE

EXISTING PATH

EXISTING FENCE

EXISTING PATH

EXISTING FENCE

CLARKE ROAD

SKYLIGHTS TO EXISTING BANKSIA ROOMS

EXISTING ADMINISTRATION & CLASSROOMS

PROPOSED MULTI-PURPOSE CLASSROOM
75.75M² TO MATCH EXISTING

UPGRADE EXISTING SEPTIC SYSTEM TO SHIRE HEALTH REQUIREMENTS

1500M² CONCRETE PEDESTRIAN PATHWAY / WAITING AREA

NEW CROSSOVER 6.0M WIDE CREATE NEW 5 STAFF CARBAYS FURTHER SOUTH

DROPOFF / PICKUP ZONE ONE WAY WITH ONE-WAY LANEWAY

Pine Log & Mesh Fence

Exit

OVVAL

INCREASE SEIBACK BY 1.60M

3035

7.600

LOT 297 ROAD RESERVE

BOUNDARY

BOUNDARY

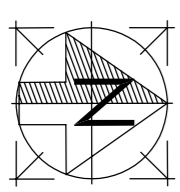

Margaret River Montessori School

SITE LAYOUT PLAN
SCALE 1:200 @ A1

bob bruce design
building design
landscape
commercial
M: 0812 272 219
E: bob@bobbrucedesign.com.au
W: www.bobbrucedesign.com.au

Project: PROPOSED ADMINISTRATION BUILDING & MULTI-PURPOSE CLASSROOMS MARGARET RIVER MONTESSORI SCHOOL 4 - 6 CLARKE ROAD MARGARET RIVER

Copyright 2021
MARGARET RIVER MONTESSORI SCHOOL
DRAWN: DAVID RYAN
CHECKED: DAVID RYAN
DATE: 14/02/21
SCALE: 1:100
SHEET NO: 02